

	<b>With Trip-activated Striker Pin</b>	<b>With Thermally-activated Striker Pin</b>
<b>Item Code</b>	S68A2080.08	S68T2080.08
<b>Description</b>	U <sub>n</sub> =12kV, I <sub>n</sub> =80A, D=292mm	
<b>Application</b>	Indoor & Outdoor	
<b>Standards</b>	IEC 60282-1, DIN 43625, VDE0670-4	

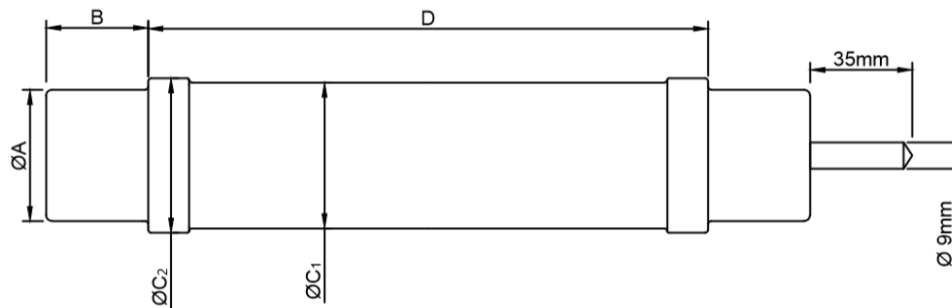

<b>MECHANICAL CHARACTERISTICS</b>						
<b>ØA</b> (±1)	<b>B</b> (+2, -0)	<b>D</b> (+0, -1)	<b>ØC<sub>1</sub></b> (±2)	<b>ØC<sub>2</sub></b> (±2)	<b>Striker Force*</b>	<b>Weight</b>
<b>mm</b>	<b>mm</b>	<b>mm</b>	<b>mm</b>	<b>mm</b>	<b>N</b>	<b>kg</b>
45	33	292	68	70	80	2,75

<b>ELECTRICAL CHARACTERISTICS</b>						
<b>Rated Voltage</b> (U <sub>n</sub> )	<b>Rated Current</b> (I <sub>n</sub> )	<b>Rated Breaking Current</b> (I <sub>1</sub> )	<b>Rated Frequency</b> (f)	<b>Minimum Breaking Current</b> (I <sub>3</sub> )	<b>Cold Resistance (R)</b> (±10%) (20°C)	<b>Power Loss</b>
<b>kV</b>	<b>A</b>	<b>kA</b>	<b>Hz</b>	<b>A</b>	<b>mΩ</b>	<b>W</b>
12	80	63	50	340	7,55	69

\*Different striker pin types and forces are available upon request. Please refer to 2<sup>nd</sup> page for selection.

### Time – Current Curve

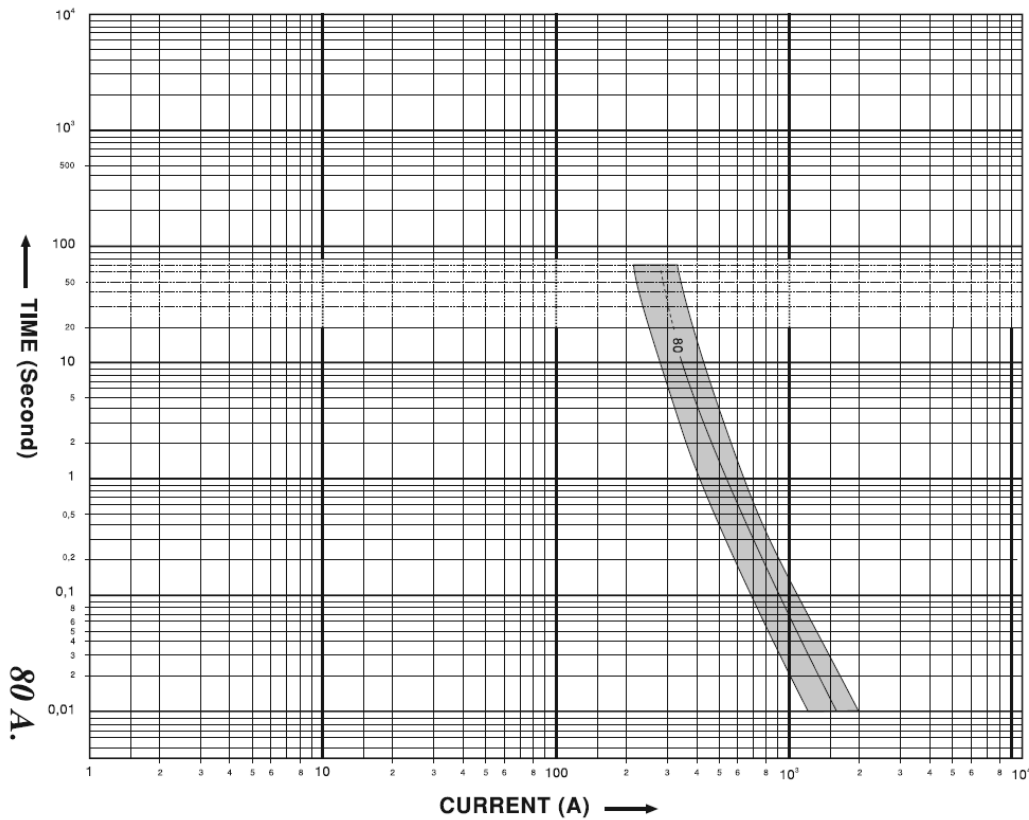

### Striker Pin Information

#### Travel – Force Diagram:

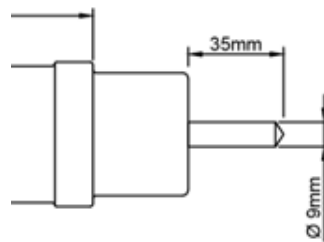
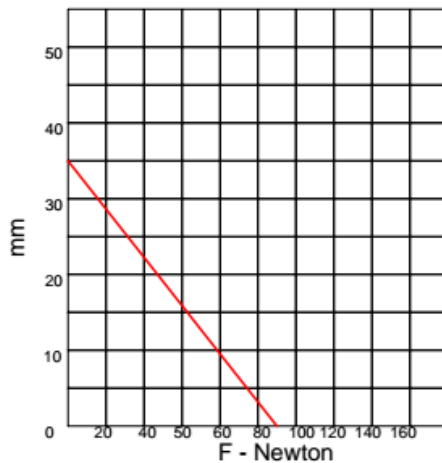

**Striker Pin:** 80N Force, medium class as per IEC 60282-1

#### Type and Force Selection:

S68□2080.□□

##### **Striker Type:**

A: Operates when fuse breaks the current  
T: Thermally activated (F=80N only)  
O: Optical indication  
Z: Without striker

##### **Striker Force:**

05: F=50N  
08: F=80N  
12: F=120N  
Not used if Striker Type digit is "O" or "Z"