

## Elbows, sweeps and accessories

### P&C duct adapters

#### Male adapter



	Cat. No.	Size (in.)	Std. Ctn.
	E943F	1	50
	E943H	1½	25
	E943J	2	50
	E943L	3	50
	E943N	4	20
	E943P	5	5
	E943R	6	10

#### Female adapter



	Cat. No.	Size (in.)	Std. Ctn.
	E942F	1	50
	E942H	1½	25
	E942J	2	30
	E942L	3	25
	E942N	4	15
	E942P	5	8
	E942R	6	6

### P&C duct swedge reducer (male x male)



	Cat. No.	Size (in.)	Std. Ctn.
	E252LJ	3 x 2	50
	E252NJS	4 x 2	25
	E252NL	4 x 3	25
	E252PN	5 x 4	20
	E252RNS	6 x 4	6
	E252RP	6 x 5	10

### P&C duct cable marker



	Cat. No.	Size (in.)	Std. Ctn.
	E299JM	2 x 42	1
	E299JR	2 x 78	1
	E299NX7	4 x 84	1

### P&C duct end bells

#### End bell



	Cat. No.	Size (in.)	Std. Ctn.
	E997F	1	50
	E997H	1½	30
	E997J	2	40
	E997L	3	50
	E997N	4	30
	E997P	5	15
	E997R	6	10

#### Molded end bell



	Cat. No.	Size (in.)	Std. Ctn.
	E297J	2	40
	E297L	3	50
	E297N	4	30
	E297P	5	15

#### Fabricated end bell



	Cat. No.	Size (in.)	Std. Ctn.
	E297JN	2 x 4	25
	E297NT	4 x 10	15
	E297PS	5 x 8	10
	E297PT	5 x 10	10
	E297RF	6 x 5	10

#### Long-length end bell P&C duct



	Cat. No.	Size (in.)	Std. Ctn.
	E297RR	6 (6 long)	10

## Conduit bodies and fittings

For use with Schedule 40 and 80 conduit



For adapting non-metallic conduits to threaded fittings, metallic systems. Female threads on one end, socket end on other.

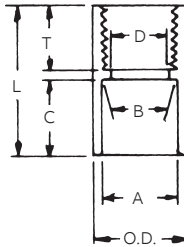

### Female adapters

Cat. No.	Size (in.)	Std. Ctn.	Typical (in.)		Min. D (in.)	Max. O.D. (in.)	Typical (in.)		
			A	B			C	S	L
E942D	1/2	150	.852	.836	.620	1 7/64	11/16	3/4	1 9/16
E942E	3/4	100	1.064	1.046	.822	1 5/16	13/16	3/4	1 5/8
E942F	1	50	1.330	1.310	1.046	1 5/8	15/16	7/8	1 15/16
E942G	1 1/4	30	1.677	1.655	1.377	1 63/64	1	7/8	2
E942H	1 1/2	25	1.918	1.894	1.607	2 5/32	1 1/8	7/8	2 7/32
E942J	2	30	2.393	2.369	2.064	2 47/64	1 3/16	1	2 5/16
E942K	2 1/2	20	2.890	2.868	2.450	3 11/32	1 5/8	1 1/8	2 15/16
E942L	3	25	3.515	3.492	3.000	3 31/32	1 3/4	1 1/8	3 1/16
E942M	3 1/2	20	4.015	3.992	3.500	4 1/2	1 7/8	1 1/8	3 1/4
E942N	4	15	4.515	4.491	4.000	5 1/64	1 3/4	1 1/16	3 13/64
▶ E942NX9*	4	15							(Call for information)
E942P	5	8	5.593	5.553	5.047	6 1/4	1 15/16	1 1/16	3 3/16
E942R	6	6	6.658	6.614	6.055	7 1/4	2 1/8	1 1/16	3 3/8
▶ E942RX*	6	6							(Call for information)

\* Long-Line Adapter



For adapting non-metallic conduits to boxes, threaded fittings, metallic systems. Male threads on one end, socket end on other.

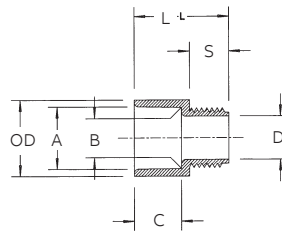

### Male terminal adapters

Cat. No.	Size (in.)	Std. Ctn.	Typical (in.)		Min. D (in.)	Max. O.D. (in.)	Typical (in.)		
			A	B			C	S	L
E943D	1/2	150	.852	.836	.594	1.042	.652	.545	1.310
E943E	3/4	125	1.064	1.046	.793	1.290	.809	.553	1.470
E943F	1	50	1.330	1.310	1.025	1.580	.965	.812	1.902
E943G	1 1/4	50	1.677	1.655	1.345	1.973	1.208	.816	1.986
E943H	1 1/2	25	1.918	1.894	1.574	2.188	1.155	.802	2.105
E943J	2	50	2.393	2.369	1.998	2.713	1.145	.825	2.093
E943K	2 1/2	25	2.890	2.868	2.400	3.290	1.490	.812	2.480
E943L	3	45	3.515	3.492	2.989	3.965	1.643	.797	2.660
E943M	3 1/2	30	4.015	3.992	3.405	4.515	1.720	.802	2.740
E943N	4	20	4.515	4.491	3.895	5.065	1.788	.733	2.830
E943P	5	5	5.593	5.553	4.900	6.104	1.935	.990	3.200
E943R	6	10	6.658	6.614	5.900	7.288	2.128	.985	3.410