

## ALUMINIUM SINGLE BARREL CONNECTOR, ONE HOLE MOUNT

MATERIAL : ALUMINIUM • FINISH : ELECTRO TINNED

| Cable<br>mm <sup>2</sup> | Stud<br>Hole E | Dimensions   |              |              |      |              | Product<br>Code |
|--------------------------|----------------|--------------|--------------|--------------|------|--------------|-----------------|
|                          |                | J            | D            | G            | E    | F            |                 |
| 4 STR                    | 14 AWG         | 27.00 (1.10) | 12.70 (0.50) | 5.95 (0.23)  | 1/4  | 2.40 (0.09)  | HLA - 4         |
| 2 STR                    | 14 AWG         | 29.40 (1.15) | 12.70 (0.50) | 7.55 (0.29)  | 1/4  | 2.75 (0.10)  | HLA - 2         |
| 1/0 STR                  | 14 AWG         | 37.10 (1.46) | 15.90 (0.62) | 11.10 (0.43) | 1/4  | 4.70 (0.18)  | HLA - 10        |
| 2/0 STR                  | 14 AWG         | 37.10 (1.46) | 15.90 (0.62) | 11.10 (0.43) | 1/4  | 4.70 (0.18)  | HLA - 20        |
| 250 KCMIL                | 6 STR          | 50.60 (2.00) | 21.75 (0.85) | 12.75 (0.50) | 5/16 | 6.40 (0.25)  | HLA - 250       |
| 300 KCMIL                | 6 STR          | 50.60 (2.00) | 21.75 (0.85) | 11.90 (0.46) | 5/16 | 6.40 (0.25)  | HLA - 300       |
| 350 KCMIL                | 6 STR          | 57.15 (2.25) | 28.60 (1.12) | 12.70 (0.50) | 3/8  | 6.40 (0.25)  | HLA - 350       |
| 500 KCMIL                | 4 STR          | 71.50 (2.81) | 38.10 (1.50) | 19.05 (0.75) | 3/8  | 8.00 (0.31)  | HLA - 500       |
| 600 KCMIL                | 2 STR          | 81.00 (3.19) | 38.10 (1.50) | 20.60 (0.81) | 3/8  | 11.10 (0.43) | HLA - 600       |
| 800 KCMIL                | 300 KCMIL      | 85.70 (3.37) | 44.50 (1.75) | 22.20 (0.87) | 5/8  | 12.70 (0.50) | HLA - 800       |
| 1000 KCMIL               | 500 KCMIL      | 85.70 (3.37) | 44.50 (1.75) | 22.20 (0.87) | 5/8  | 12.70 (0.50) | HLA - 1000      |

## ALUMINIUM DOUBLE BARREL CONNECTOR, ONE HOLE MOUNT

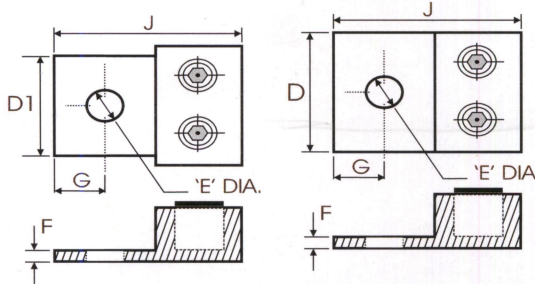
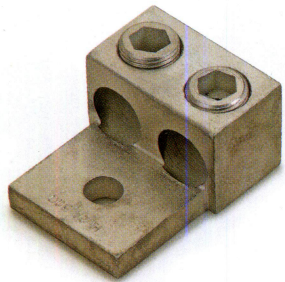

MATERIAL : ALUMINIUM • FINISH : ELECTRO TINNED

| Cond. Ram. (Al. or Cu.) |           | Dimensions   |              |              |     |             |             | Product<br>Code |
|-------------------------|-----------|--------------|--------------|--------------|-----|-------------|-------------|-----------------|
| Max.                    | Min.      | J            | D            | G            | E   | F           | D1          |                 |
| 1/0 STR                 | 14 AWG    | 37.10 (1.46) | 30.95 (1.22) | 11.10 (0.43) | 1/4 | 4.70 (0.18) | -           | HL2A - 10       |
| 2/0 STR                 | 14 AWG    | 37.10 (1.46) | 31.75 (1.25) | 10.70 (0.42) | 1/4 | 4.70 (0.18) | -           | HL2A - 20       |
| 250 KCMIL               | 6STR      | 65.10 (2.56) | 41.70 (1.64) | 22.20 (0.87) | 3/8 | 6.40 (0.25) | 38.1(1.50)  | HL2A - 250      |
| 350 KCMIL               | 6 STR     | 73.00 (2.87) | 48.60 (1.91) | 22.20 (0.87) | 1/2 | 6.40 (0.25) | 44.8 (1.76) | HL2A - 350      |
| 600 KCMIL               | 2 STR     | 81.00 (3.19) | 61.10 (2.40) | 15.90 (0.62) | 1/2 | 11.10(0.43) | 50.4 (1.98) | HL2A - 600      |
| 800 KCMIL               | 300 KCMIL | 85.70 (3.37) | 80.90 (3.18) | 22.20 (0.87) | 5/8 | 12.70(0.50) | 50.4 (1.98) | HL2A - 800      |
| 1000 KCMIL              | 500 KCMIL | 85.70 (3.37) | 80.90 (3.18) | 22.20 (0.87) | 5/8 | 12.70(0.50) | -           | HL2A - 1000     |

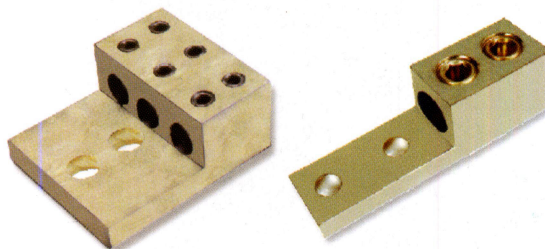

Other types and sizes of Aluminium Mechanical lugs like 2 Hole Palm - 2 Hole Screw, 3 Hole Palm - 2 Hole Screw, 3 Hole Palm - 3 Hole screw etc. can be made on demand and/or customers specifications.