

Compression Connections

BURNDY® Products

Copper Compression — Code — Inspection Window

TWO HOLE HYLUG™ CODE CONDUCTOR STANDARD BARREL

(Continued)

UL Listed 90° C,
600 Volts to 35 kV ◆

45° and 90° angles are available.
Please contact Customer Service to order:
1-800-346-4175

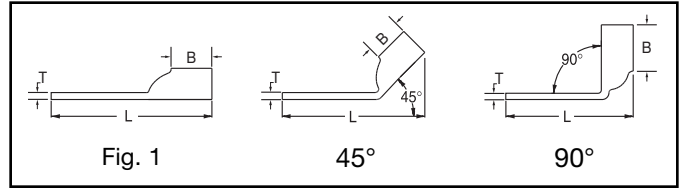

Catalog Number	Fig #	Conductor		Stud Hole Size	Stud Hole Spacing	Tongue Width	Figure Dimensions			▲ Installation Tooling					Wire Strip Length						
		AWG	MM ²				(B)	(T)	(L)	Dieless (# of crimps)	Mechanical	Hydraulic		Color Code		Die Index					
											MD6, OUR840, MD7-34R	BCT500HS, Y500CTHS	Y35, Y39, Y750, Y46*, PAT750								
YA4C-2L	1	4 AWG	—	1/4"	5/8"	.49"	.81"	.09"	2.30"	Y1MRTC (2) MY29-3 (1) MY29-11 (1) MRC840 (1) Y644HS (1) Y81KFT (1) Y81KFTMBH (1) PAT81KFT-18V (1)	W4CVT (1) W4CRT (1) X4CRT (1)	W4CVT (1) W4CRT (1) X4CRT (1)	U4CRT (1) U6CABT (1)	Gray	8	7/8"					
YA4CL-2TC14	1			1/4"	5/8"	.49"	.81"	.09"	2.36"	W3CRT (1) W3CRT (1)	W3CRT (1) W3CRT (1)	U3CRT (1)	White	9	15/16"						
YA4CL-2TC38	1			3/8"	1"	.58"	.81"	.08"	2.96"												
YA4CL-2TC14E1	1			1/4"	1"	.49"	.81"	.09"	2.74"												
YA4C-2LN	1	4 AWG	—	1/2"	1-3/4"	.83"	.81"	.12"	4.14"	Y1MRTC (2) MY29-3 (1) MY29-11 (1) MRC840 (1) Y644HS (1) Y81KFT (1) Y81KFTMBH (1) PAT81KFT-18V (1)	W4CVT (1)	X4CRT (1)	U4CRT (1)	Gray	8	7/8"					
YA4CL-2TC14E2	1			1/4"	3/4"	.49"	.81"	.09"	2.49"												
YA4CL-2TC516	1			5/16"	1"	.52"	.81"	.09"	2.80"												
YA3CL-2TC14	1	3 AWG #2 Sol.	25	1/4"	5/8"	.55"	.81"	.09"	2.45"		W2CVT (1) W2CRT (1) X2CRT (1)	W2CVT (1) W2CRT (1) X2CRT (1)	U2CRT (1)	Brown	10	15/16"					
YA3C-2L	1			5/16"	5/8"	.55"	.88"	.09"	2.64"												
YA3CL-2TC38	1	3/8"	1"	.58"	.88"	.08"	3.06"	W1CVT (1) W1CRT-1 (1) X1CRT-1 (1)	W1CVT (1) W1CRT-1 (1) X1CRT-1 (1)		U1CRT-1 (1) U4CABT (1)	Green	11	15/16"							
YA2C-2L	1	2 AWG	35	5/16"	3/4"	.60"	.88"								.11"	2.67"					
YA2C-2LN	1			1/2"	1-3/4"	.83"	.88"								.11"	4.27"					
YA2CL-2TC14	1			1/4"	5/8"	.60"	.88"								.11"	2.47"					
YA2CL-2TC14E1	1			1/4"	1"	.60"	.88"								.11"	2.85"					
YA2CL-2TC14E2	1	1/4"	3/4"	.60"	.88"	.11"	2.60"								W25VT (2) W25RT (2) X25RT (2)	W25VT (2) W25RT (2) X25RT (2)	U25RT (1) U2CABT (1)	Pink	12	15/16"	
YA2CL-2TC38	1	3/8"	1"	.60"	.88"	.11"	3.03"														
YA2CL-2TC516	1	5/16"	1"	.60"	.88"	.11"	2.91"														
YA1C-2LN	1	1 AWG	50	1/2"	1-3/4"	.81"	.88"			.12"											4.32"
YA1C-2L	1			5/16"	7/8"	.68"	.88"			.10"					2.82"						
YA1CL-2TC14	1			1/4"	5/8"	.68"	.88"			.10"					2.51"						
YA1CL-2TC14E2	1			1/4"	3/4"	.68"	.88"			.10"					2.64"						
YA1CL-2TC38	1	—	—	3/8"	1	.68"	.88"	.10"	3.07"	W26VT (2) W26RT (2) X26RT (2)	W26VT (2) W26RT (2) X26RT (2)	U26RT (1)	Black	13	1"						
YA25-2L	1	1/0 AWG	—	5/16"	7/8"	.75"	.88"	.12"	2.85"												
YA25-2LN	1			1/2"	1-3/4"	.83"	.88"	.11"	4.29"												
YA25L-2TC14	1			1/4"	5/8"	.75"	.88"	.12"	2.64"												
YA25L-2TC14E1	1			1/4"	1"	.75"	.88"	.12"	3.01"												
YA25L-2TC14E2	1	1/4"	3/4"	.75"	.88"	.12"	2.66"	W27VT (2) W27RT (2) X27RT (3)	W27VT (2) W27RT (2) X27RT (3)							U27RT (1)	Orange	14	1-1/16"		
YA25L-2TC38	1	3/8"	1"	.75"	.88"	.12"	3.10"														
YA26-2L	1	2/0 AWG	70	5/16"	7/8"	.83"	.94"													.12"	2.95"
YA26-2LN	1			1/2"	1-3/4"	.83"	.94"													.12"	4.39"
YA26L-2TC14	1			1/4"	5/8"	.83"	.94"	.12"	2.64"												
YA26L-2TC14E1	1			1/4"	1"	.83"	.94"	.12"	3.01"												
YA26L-2TC14E2	1	1/4"	3/4"	.83"	.94"	.12"	2.76"	Y81KFTMBH (1) PAT81KFT-18V (1)													
YA26L-2TC38	1	3/8"	1"	.83"	.94"	.12"	3.20"														
YA27-2LN	1	3/0 AWG	—	1/2"	1-3/4"	.91"	1.00"		.13"	4.48"											
YA27L-2TC14E2	1			1/4"	3/4"	.91"	1.00"		.12"	2.86"											
YA27L-2TC38	1			3/8"	1"	.91"	1.00"	.12"	3.30"												

-- Color code not assigned.
▲ See tooling section of this catalog for complete tool and die listings.

◆ For applications greater than 2000 volts consult cable manufacturer for voltage stress relief instructions.
* Use PUADP-1 adapter with "U" dies in Y46 HYPRESS™.

** P-RT die sets for use in Y46 HYPRESS™ only, PUADP-1 adapter not required.
*** The MM² conductor sizes listed are the recommendations for Class 2 conductor.
Note: All dimensions shown are for reference only.

Throughout the catalog you will notice blue highlighted items. These are the most frequently ordered BURNDY® Products.